

Plaza Space

Retrofitting For The Future

North Canal Street

Parking Space

Water Infiltration

Open and
Closed Flexibility

Grab and GO
and Local Food



The hope for this design is to provide a retrofitted installation that will assist the community while phasing this street towards a closed pedestrian street. It will have out door recreational space, traffic calming technology, green infrastructure, and adjacent food based retail. The new geometry of the plaza will make it an ample space for weekend closures with flexible furnishing for festivals while still being a safe place to drive during the week.

Street Programing

Public Street
Retail

Public Plaza
and Seating

Green
Infrastructure

Mixed Use First
Floor Food Retail

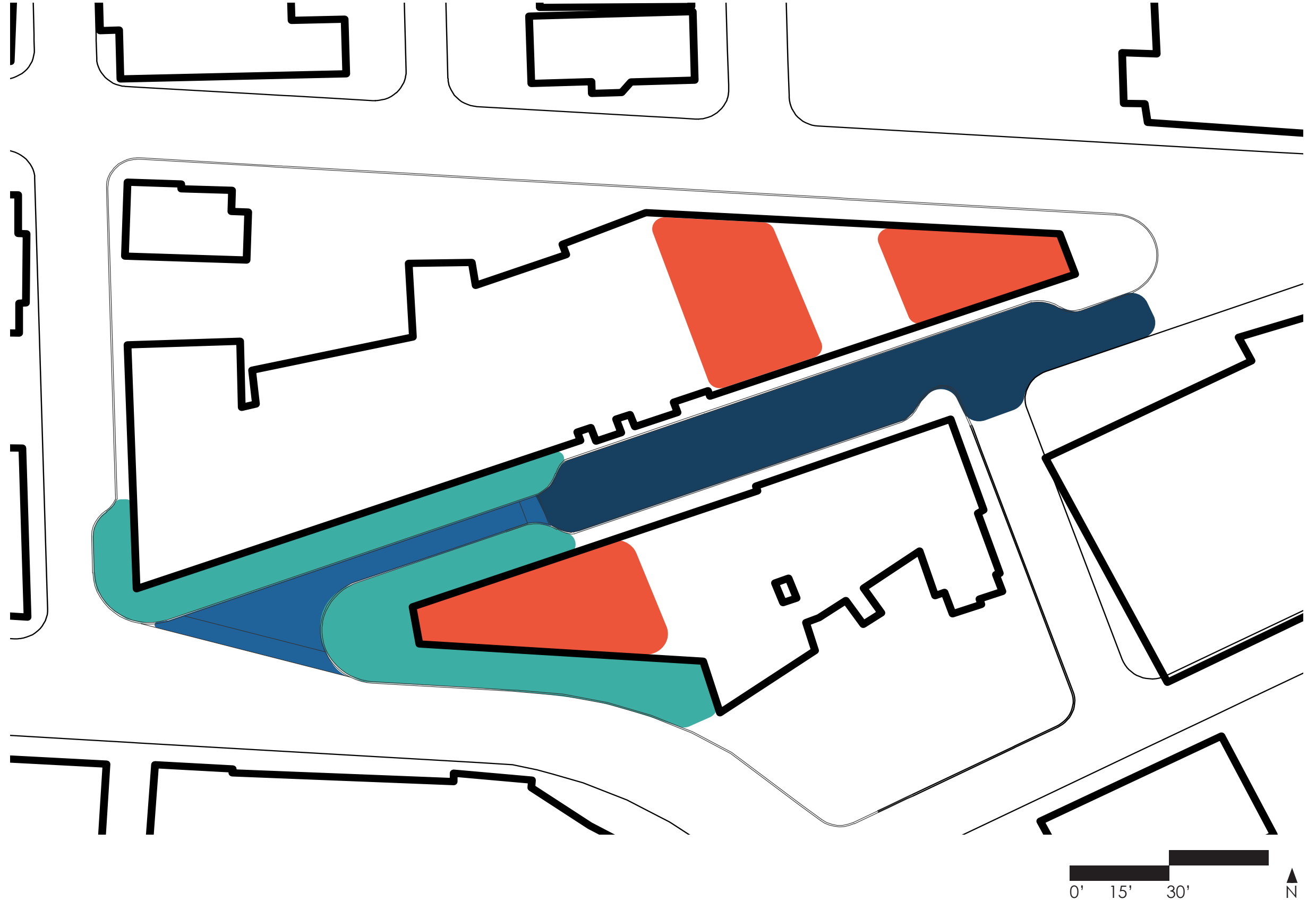

Open Street Circulation

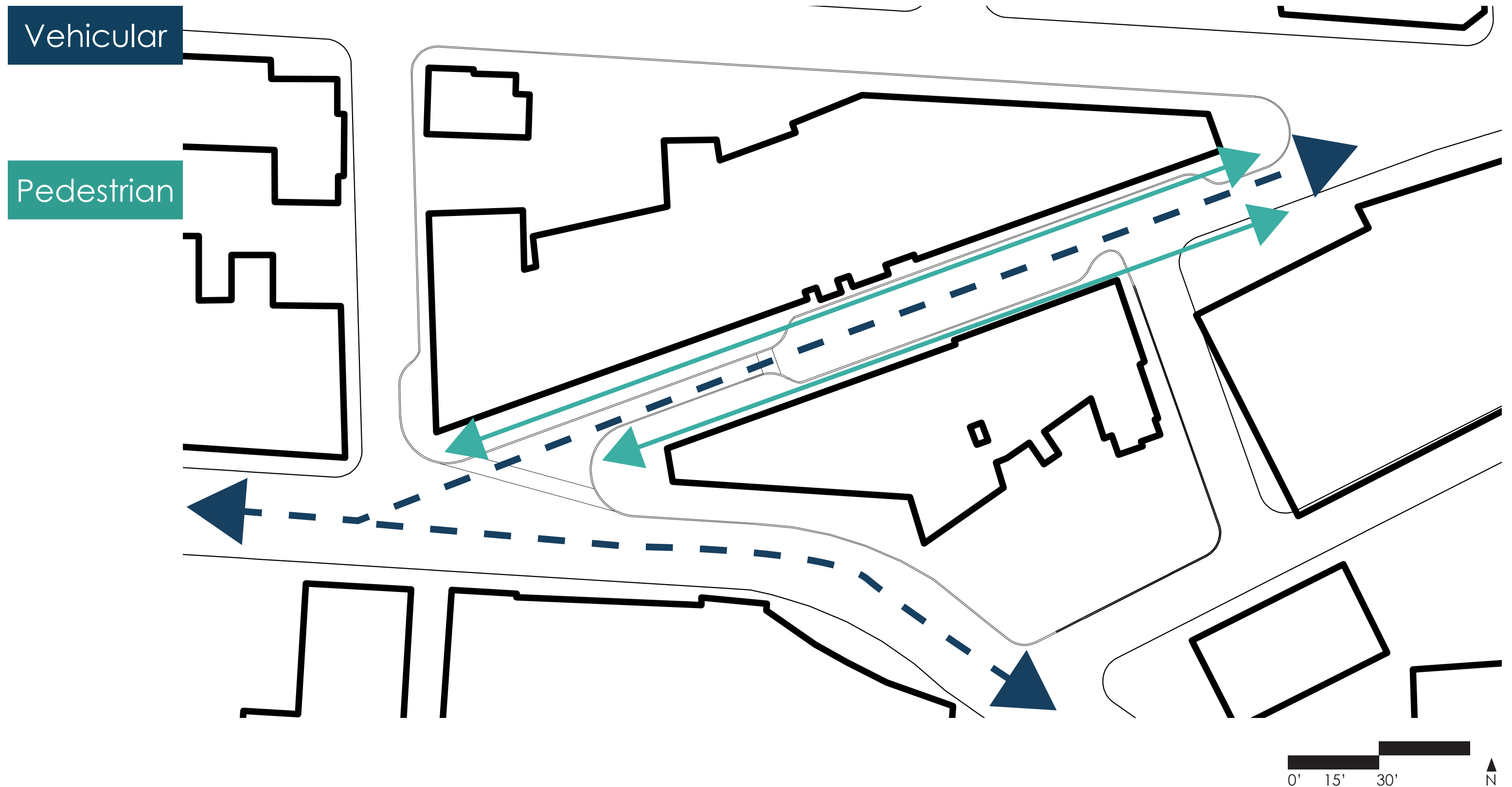

Closed Street Circulation

Vehicular

Pedestrian

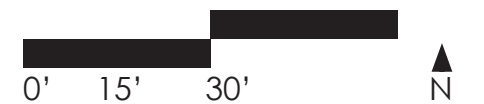
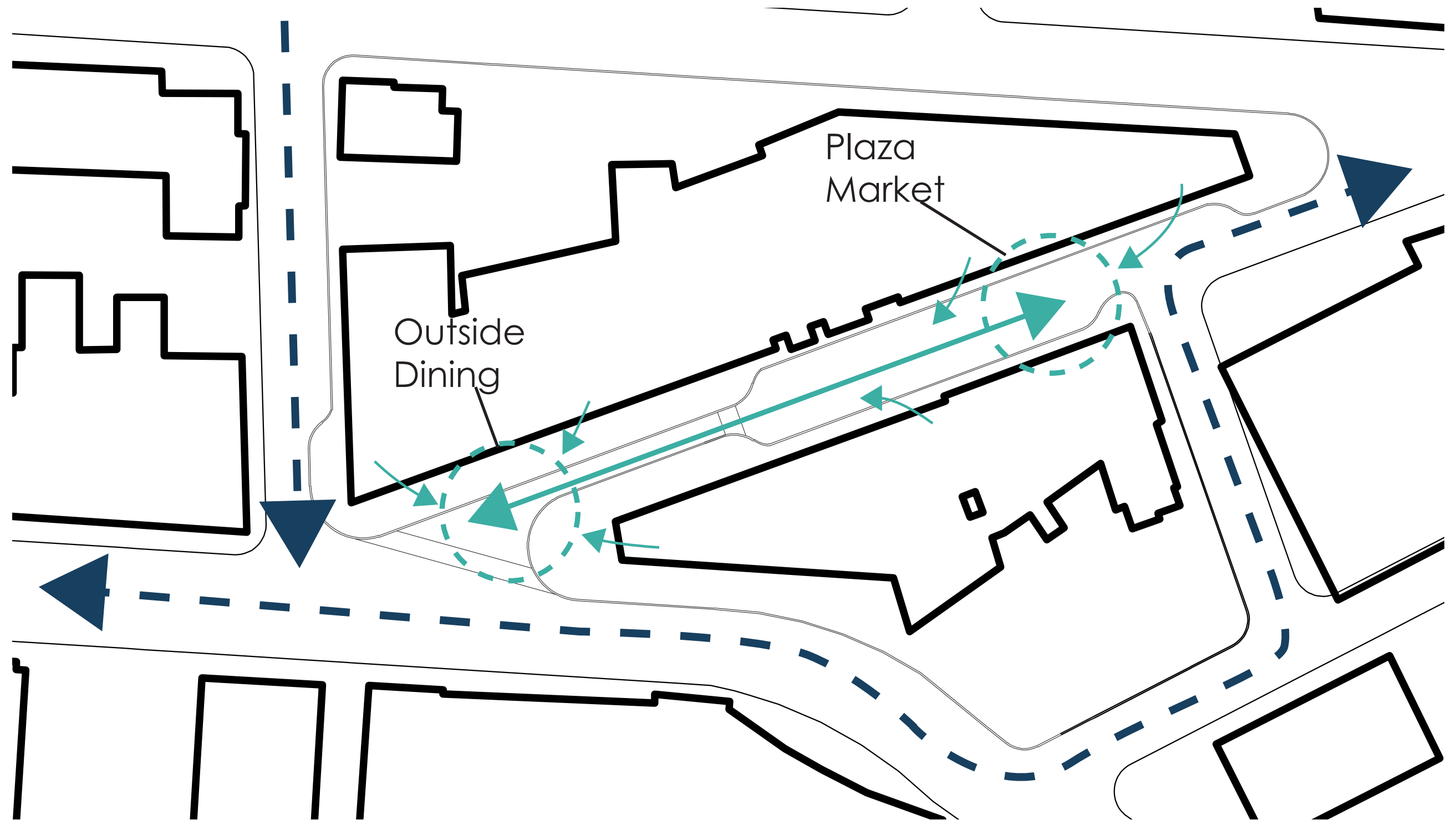

Planting and Furnishing

12	Gleditsia triacanthos	Honey locust	B@B	Placed By LA
5	Perennials	Seed Mix	In Planters	Chosen By LA
21	Bench Seating	MFG Co.	Wooden	
5	Rolling Planter	Planters Unlimited	Fiber Glass	
10	Street String Lights	AQLighting		

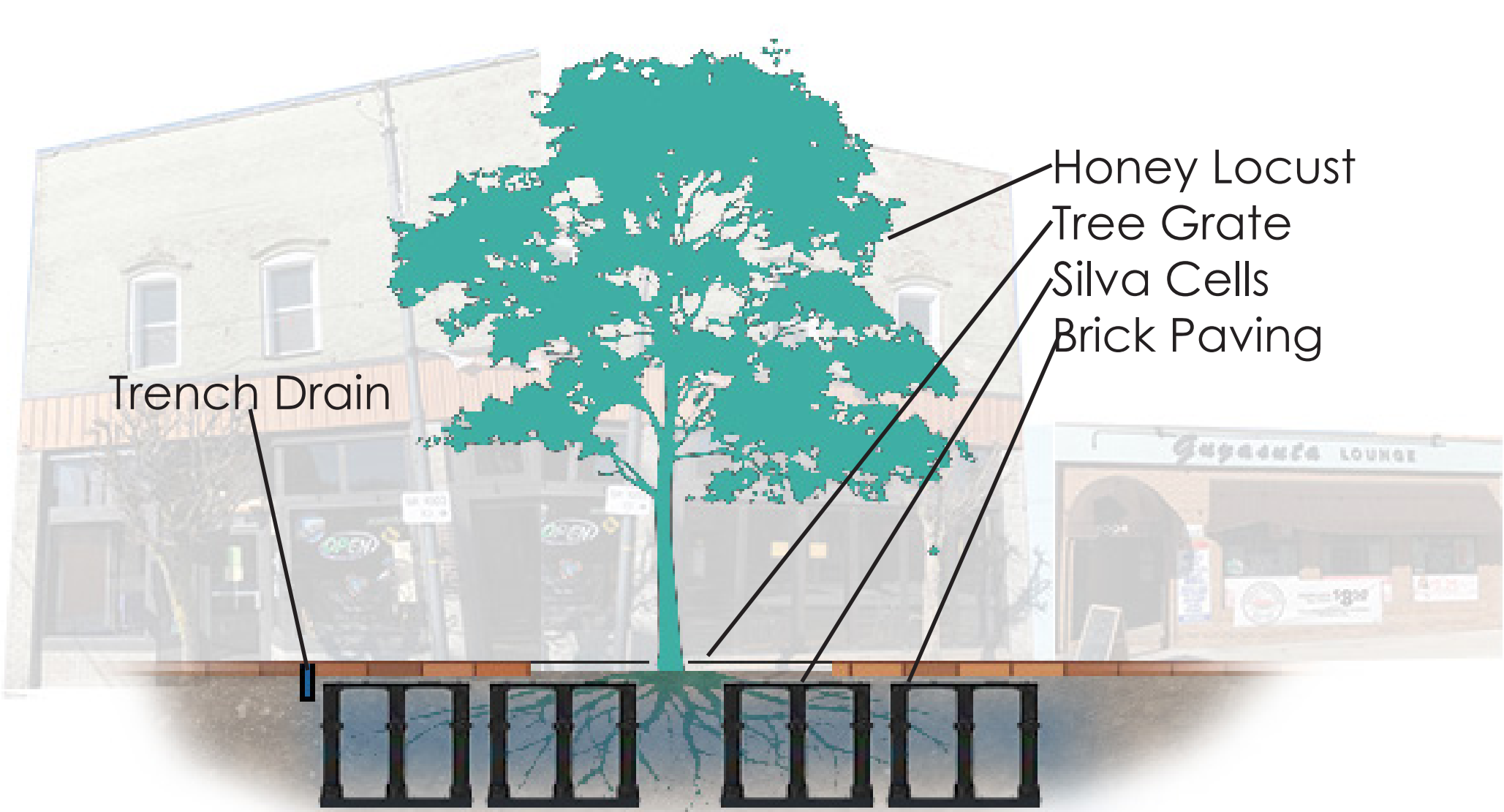
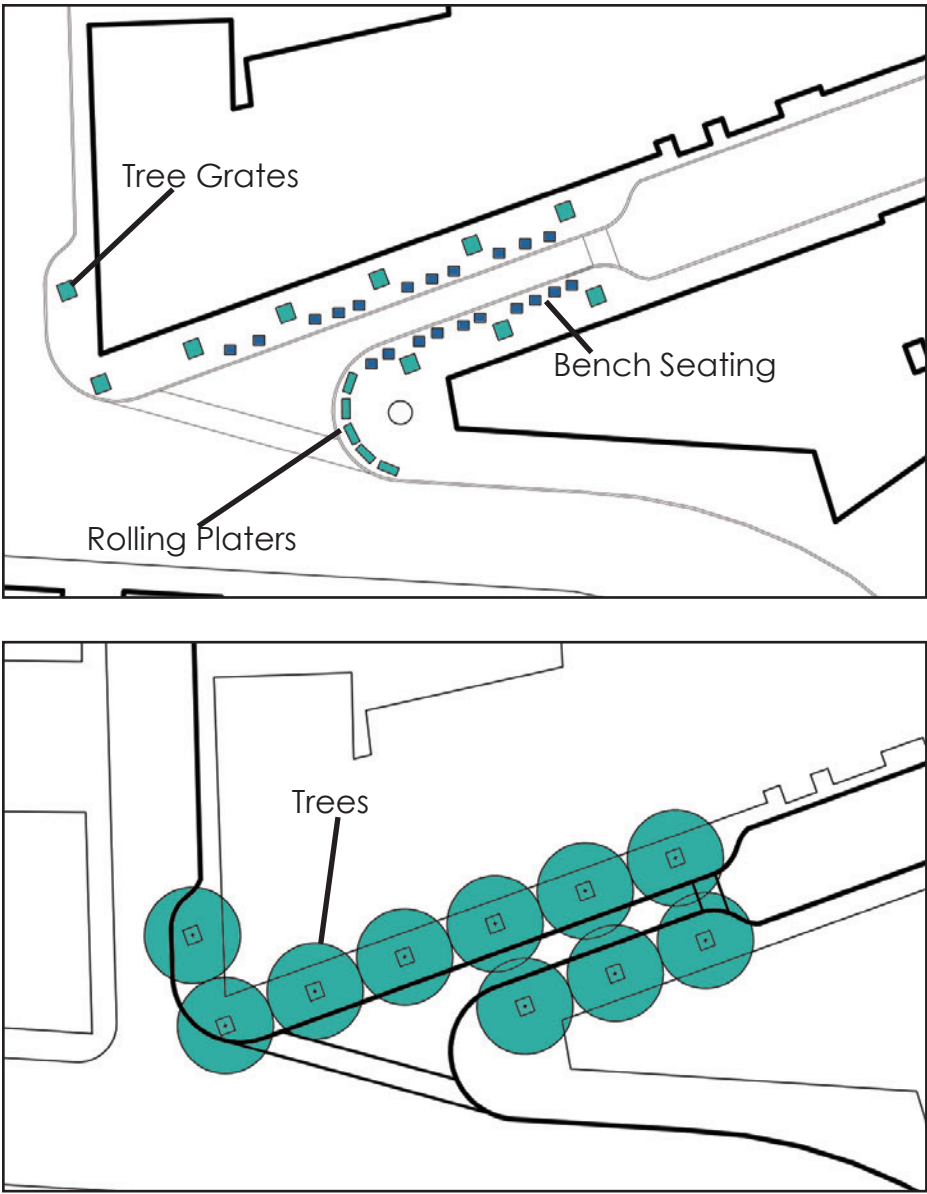

The Pedestrian Canal Street

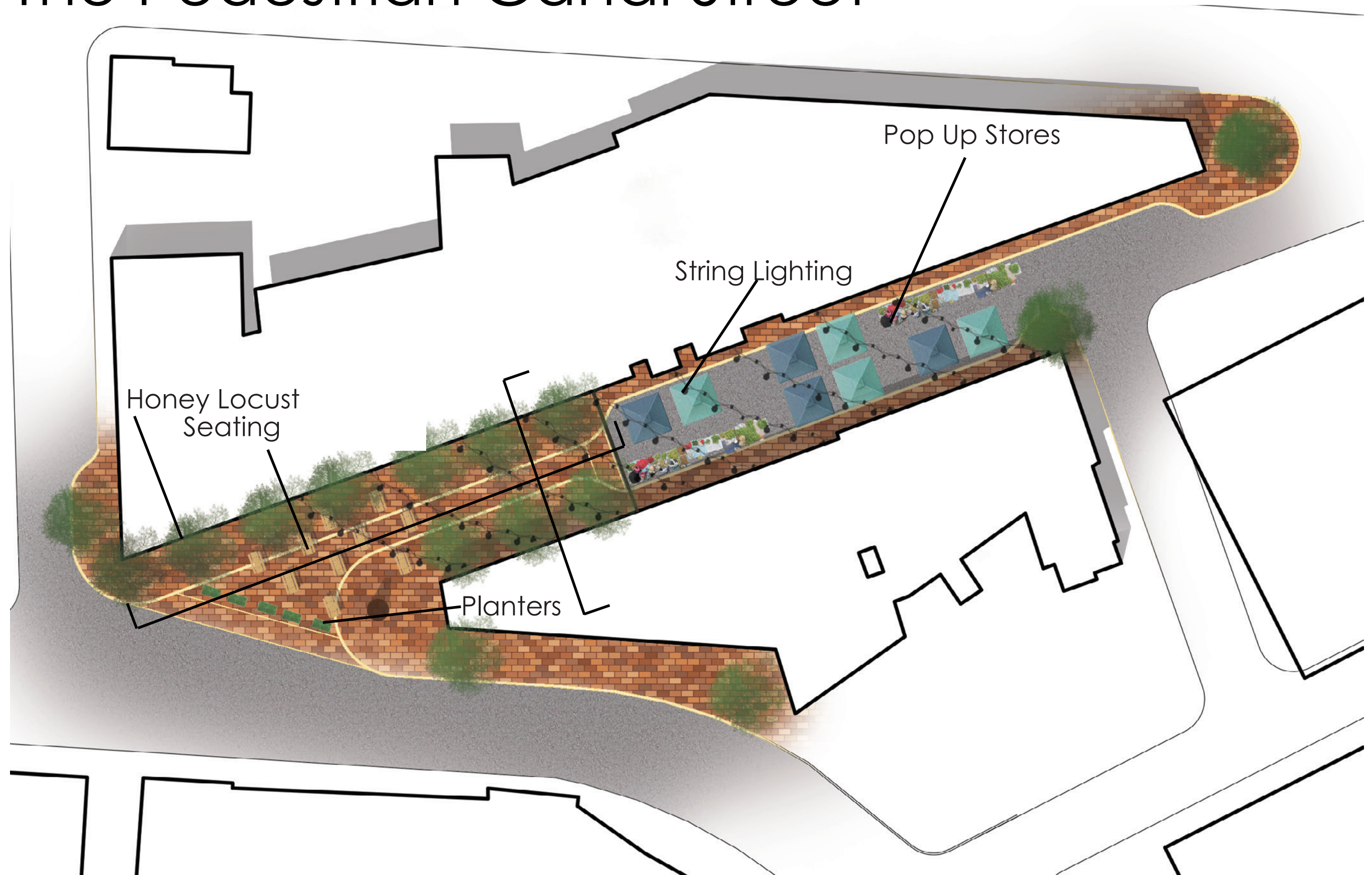

Market Section

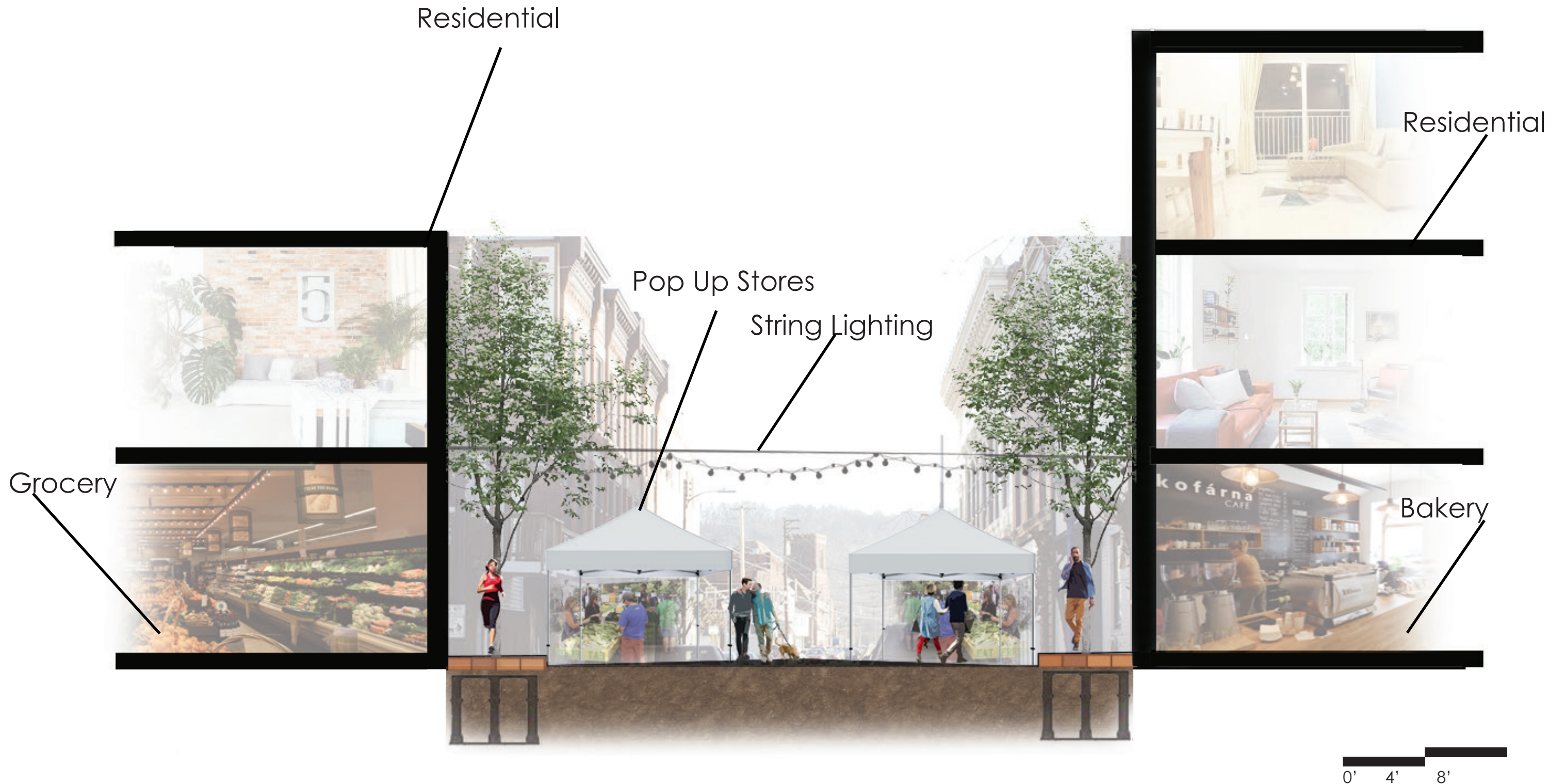

Plaza Section

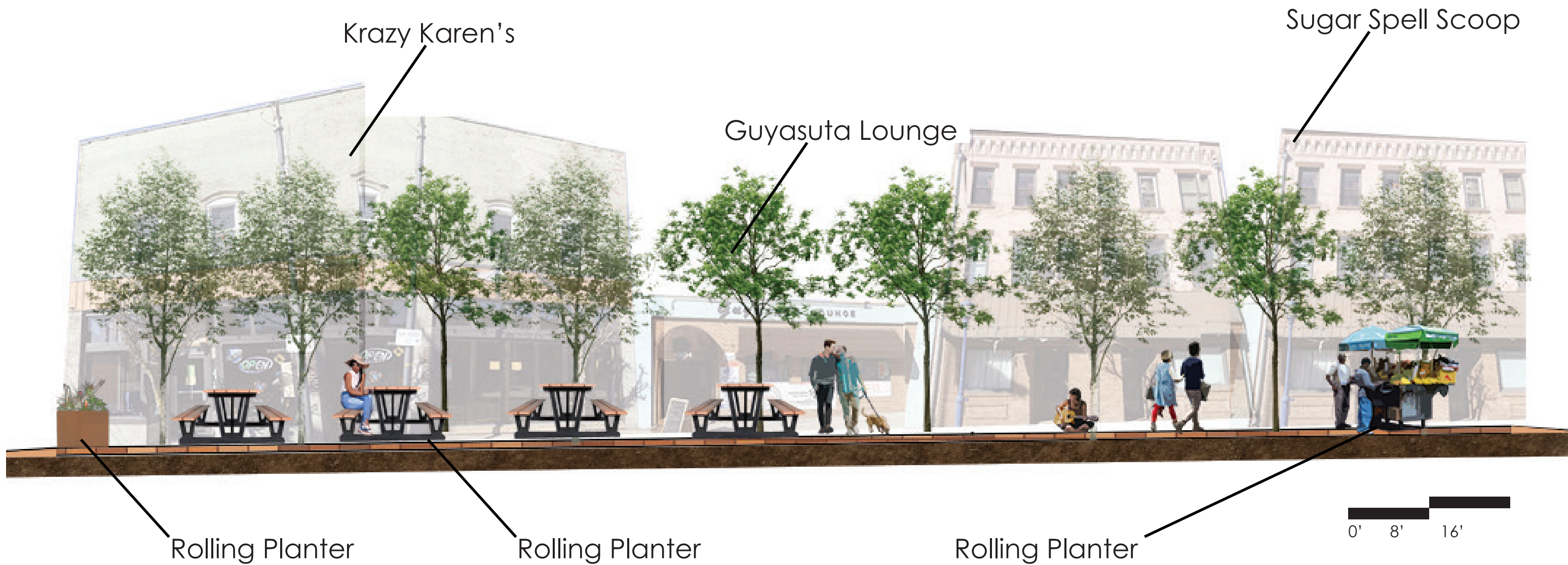



Lucas Rizzo, LArch 414 Pittsburgh Studio, Penn State Landscape Architecture, Spring 2021