

TRIBORO GATEWAYS

Central & Easterly Gateways

LArch 414 Pittsburgh Studio

Andrew Knerr



GATEWAYS CONTEXT MAP



Best from the Charette

Vegetation to enhance aesthetics and mitigate noise

Public art
installations to add
color and vibrancy

Stormwater management and best practices



Color LED lighting
to liven spaces up
and make it feel
safer at night

Wayfinding and signage

Pedestrian access
and safety in and
around the site

CENTRAL GATEWAY COMMUNITY INPUT

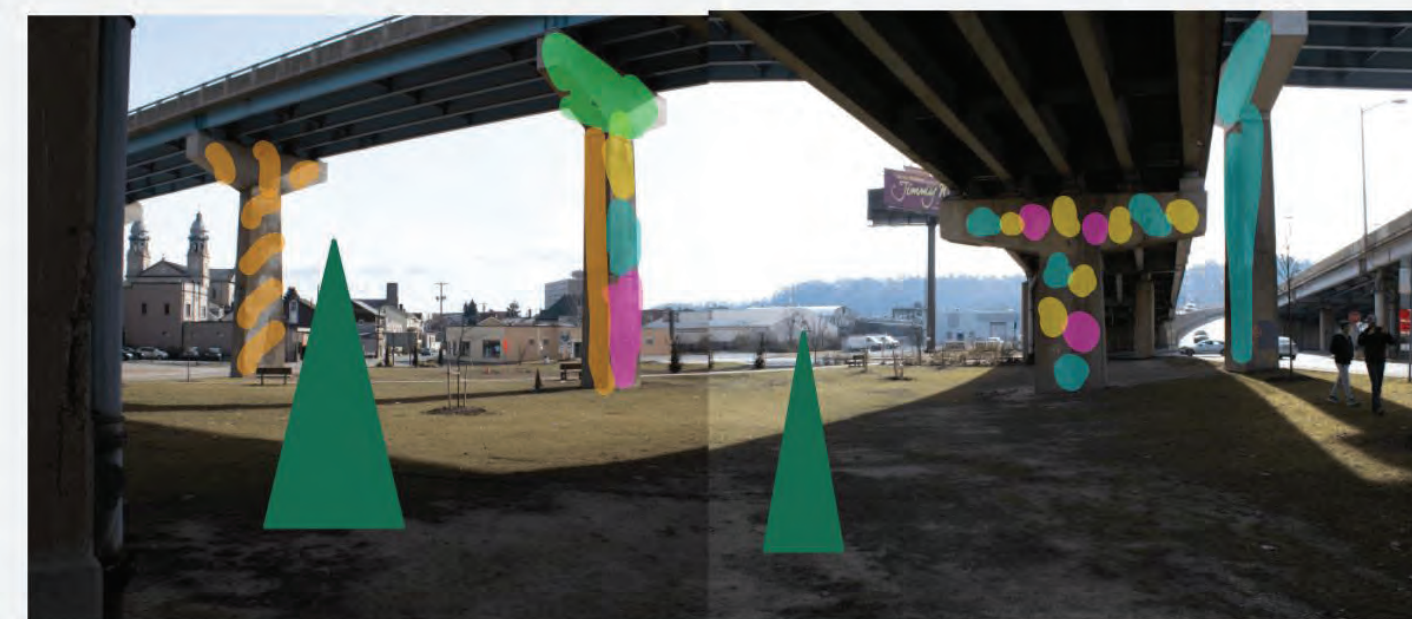

How does this image make me
Feel?

Cavernous, noisy,
overwhelmingly car centric
and urban, dirty and no safe
way to get there really

Oppressed/constrained - by overpass/traffic/pollution, inhabitants an afterthought to planning

What would a magic button do to this space?

A way to add color, and life and trees. Maybe some shady spots that are organic shapes. Public art, again, to calm traffic and slow people down. Better access.

Light to combat the shadow of the overpass, signage/art indicating where one is, trees/flowers, benches, reconnect Sharpsburg and Etna to each other

EASTERLY SHARPSBURG GATEWAY COMMUNITY INPUT



How does this image make me Feel?

This is such a sad entrance
It does not make you want
to find out more about the
town

La Dorita (cow building) is more welcoming than anything else in this image

What would a magic button do to this space?

ART WE NEED SOME ART
color life design, welcome
sign....and TREES

Colorful shrubs/flowers along guardrail, art installations, mixed use area for parking lot (?? don't know how used it is)

ETNA SHARPSBURG COMMUNITY GREEN SPACE



COMMUNITY GREEN SPACE PERSPECTIVE

Concept Statement

The concept for this design is to enhance the identity of this central gateway by adding human scale programs and making this site more accessible to the people living in Etna and Sharpsburg. From the community charrette we held earlier in the semester, community members vocalized their want for more vegetation, access to Pine Creek, more public art, safer access, and space to hold community events. A rubber path system extends through the park reaching out to both the Etna side and Sharpsburg side giving these community members access. New artistic pedestrian crossings will be implemented on the street to not only slow down traffic but to also provide a fun and aesthetic entrance to the center site. A terraced riparian buffer next to Pine Creek will provide access up to the water as well as tables and seating underneath the highway overpasses.

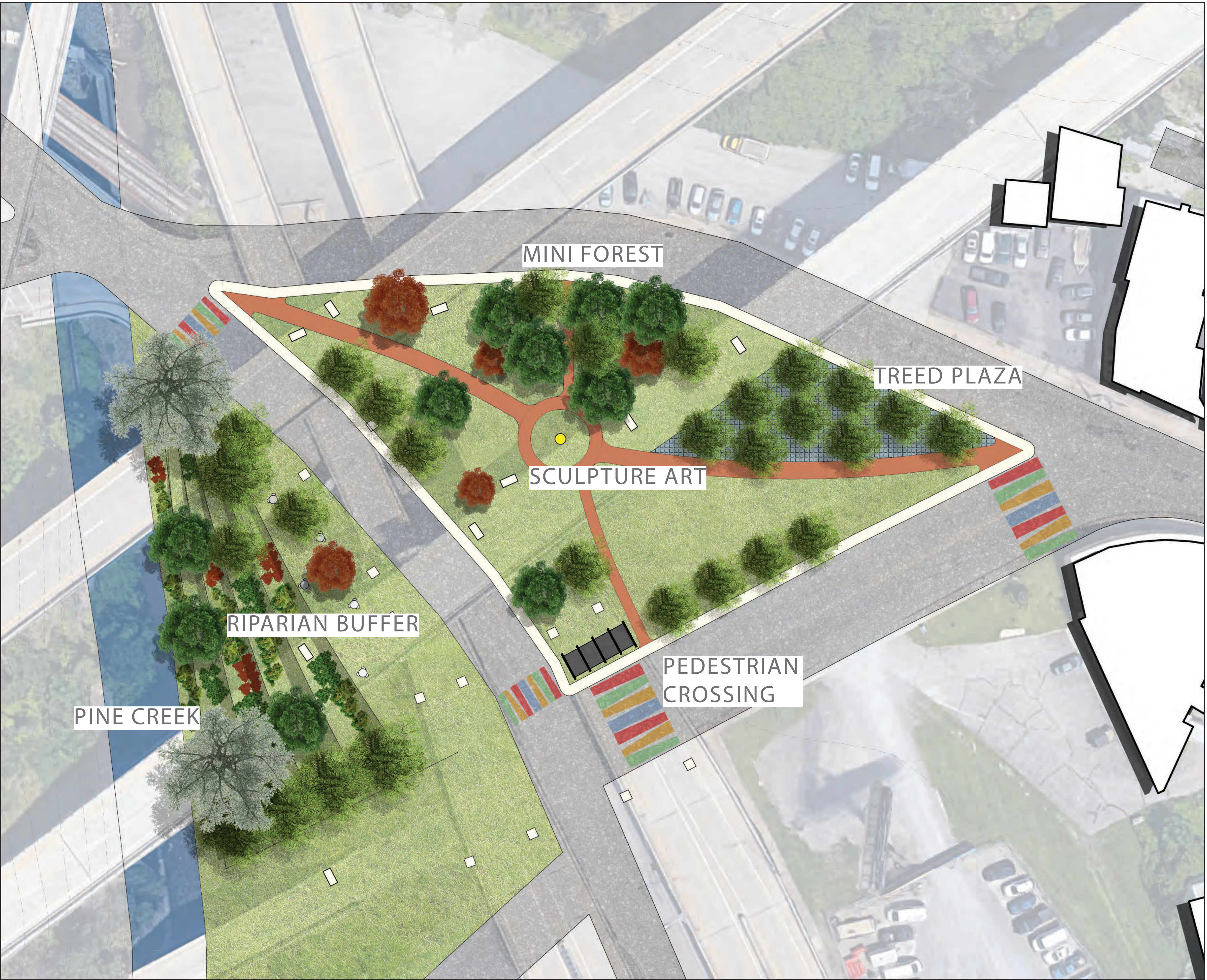

ETNA/ SHARPSBURG COMMUNITY GREEN SPACE PLAN

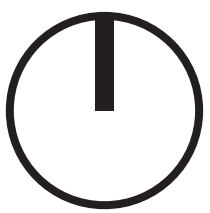

ETNA SHARPSBURG COMMUNITY GREEN SPACE |

Mini Forest & Riparian Buffer



MINI FOREST AXON



Northern red oak



Tulip tree



American beech



Serviceberry



American witchhazel



Amer. cran. bush



Cinnamon fern



Staghorn sumac



Wild hyacinth

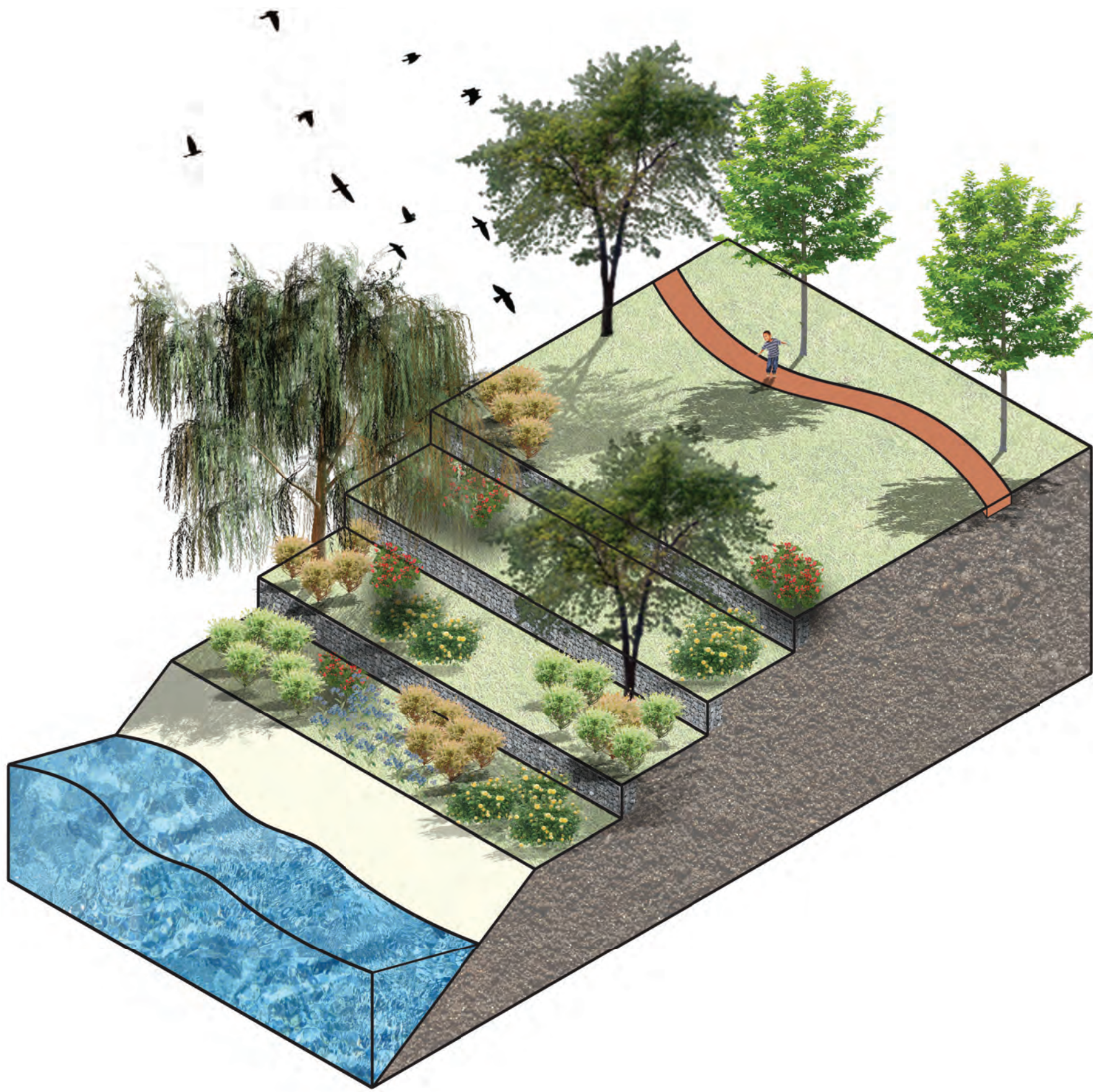

TERRACED RIPARIAN BUFFER AXON

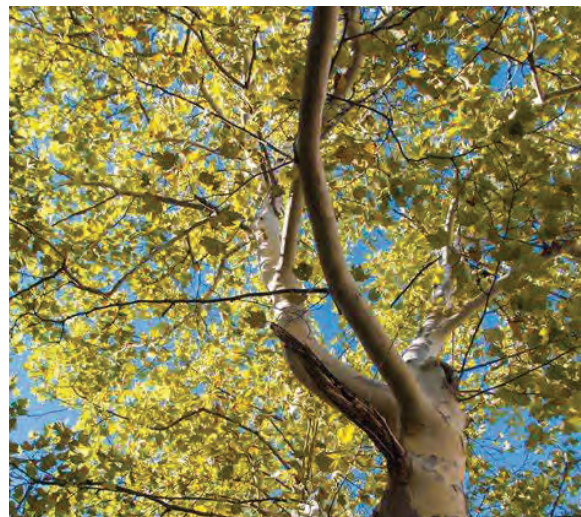

Amer. sycamore



Weeping willow



River birch



Red-osier dogwood



Pussywillow



Bald cypress



Blue-eyed grass



Joe pye weed



Cardinal flower

Category	Scientific name	Common Name
Trees		
	Acer rubrum	Red maple
	Amelanchier arborea	Autum brilliance serviceberry
	Fagus grandifolia	American beech
	Hamamelis virginiana	American witchhazel
	Liriodendron	Tulip tree
	Quercus alba	White oak
	Quercus rubra	Northern red oak
Shrubs		
	Rhus typhina	Staghorn sumac
	Viburnum opulus var. americanum	American cranberry bush
Ground flora		
	Adiantum pedatum	Northern maidenhair fern
	Arisaema triphyllum	Jack-in-the-pulpit
	Asarum canadense	Wild ginger
	Camassia scilloides	Wild hyacinth
	Claytonia virginica	Virginia spring beauty
	Erythronium americanum	Yellow trout Lily
	Leucobryum glaucum	Cushion moss
	Mertensia virginica	Virginia bluebell
	Osmunda cinnamomea	Cinnamon fern
	Panax quinquefolius	American ginseng
	Polystichum acrostichoides	Christmas fern
	Silene virginica	Fire pink
	Tiarella cordifolia	Heartleaf foamflower
	Trillium erectum	Red trillium

Category	Scientific name	Common Name
Lower 50 ft.		
Trees		
	Betula nigra	River birch
	Platanus occidentalis	American sycamore
	Salix babylonica	Babylon weeping willow
Shrubs & Ground flora		
	Alnus serrulata	Smooth alder
	Blue lobelia	Blue cardinal flower
	Cephalanthus occidentalis	Buttonbush
	Cornus sericea	Red-osier dogwood
	Ilex verticillata	Winterberry
	Juncus effusus	Soft Rush
	Lobelia cardinalis	Cardinal flower
	Salix discolor	Pussywillow
	Salix exigua	Sandbar willow
Upper 50 ft.		
Trees		
	Acer saccharinum	Silver maple
	Populus tremuloides	Quaking aspen
	Taxodium distichum	Bald cypress
Shrubs & Ground flora		
	Aronia melanocarpa	Black chokeberry
	Eutrochium purpureum	Joe pye weed
	Ilex verticillata	Winterberry
	Myrica pensylvanica	Bayberry
	Physocarpus opulifolius	Ninebark
	Rubus alleghenensis	Allegheny blackberry
	Sisyrinchium angustifolium	Blue-eyed grass
	Viburnum dentatum	Arrowwood viburnum

SHARPSBURG GATEWAY

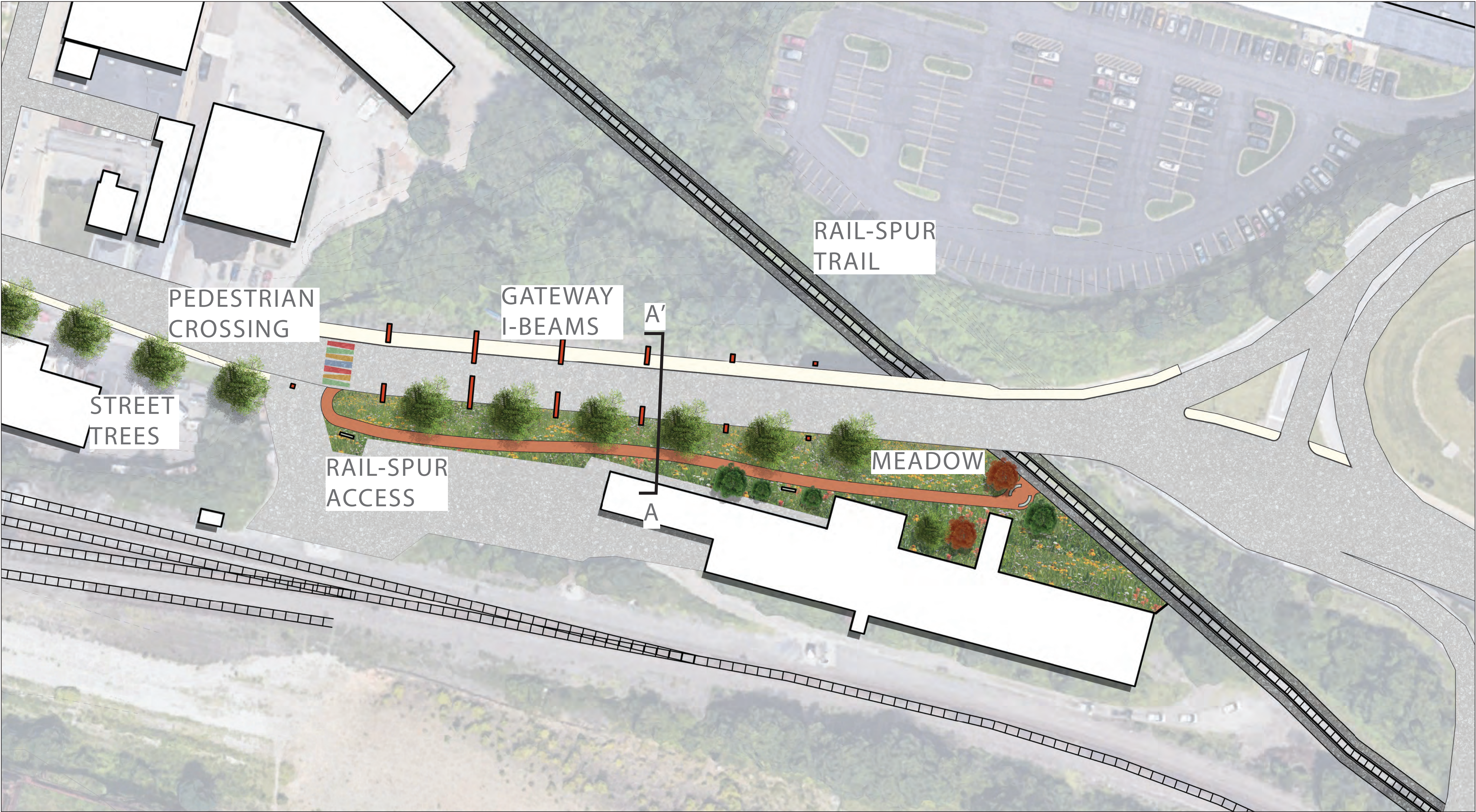

Concept Statement

The concept for this Sharpsburg Gateway is to create an entry experience to Sharpsburg and provide this community with walkable and bikable access to the rail spur underneath Freeport Road. Vertical and slanted plastic I-beams coated in ASTM 588 (rusted steel looking plastic) will give vehicles passing through a gateway experience to Sharpsburg. Street trees will be planted along Freeport Road/ Main Street to enhance the aesthetic of this road and draw pedestrians to the new path leading to the rail spur underneath. Along this path leading to a resting area before the rail spur will be a planted meadow for the enjoyment of anyone using it. The new path along the rail-spur will connect up to Heinz Memorial Park located north west of this gateway.

SHARPSBURG GATEWAY & RAIL SPUR PLAN

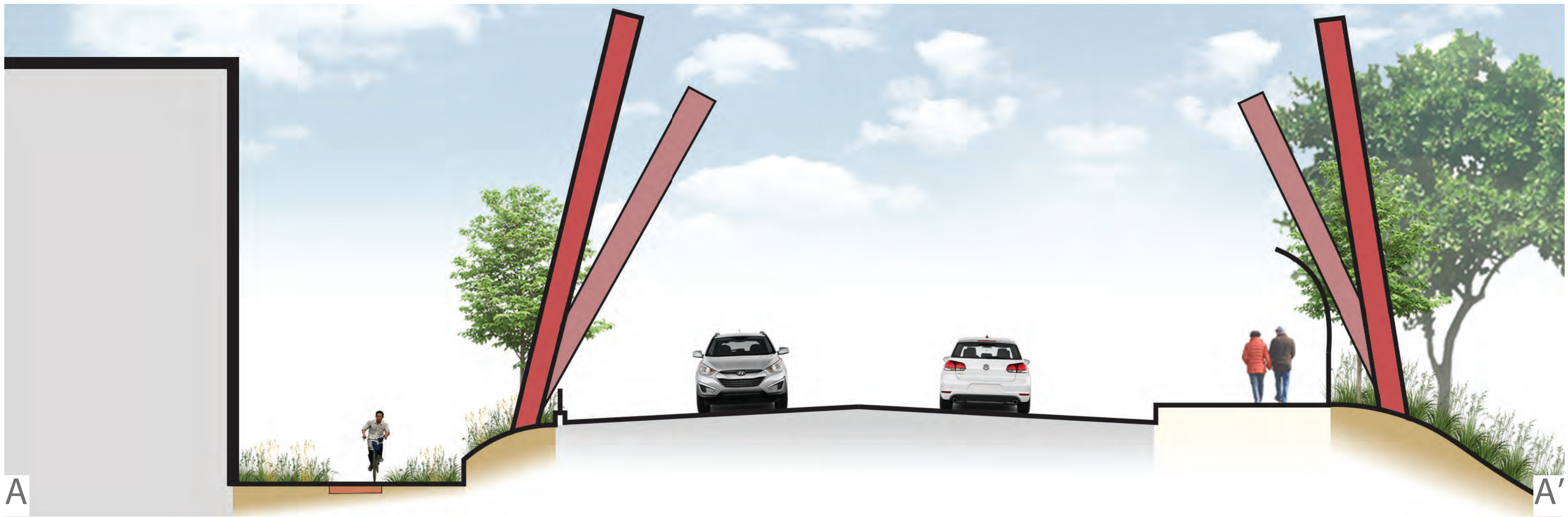
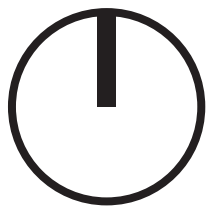

SHARPSBURG GATEWAY & RAIL SPUR SECTION

SHARPSBURG GATEWAY | Meadow and Gateway Feature



SHARPSBURG GATEWAY PERSPECTIVE



MEADOW BIKE PATH AXON



Creeping red fescue



Orchardgrass



Fowl blue grass



Amer. dragonhead



Yellow cohosh



App. flameflower



Scarlet beebalm



Bluntleaf



Lavender hyssop

		Scientific Name	Common name	% Weight of Seed Mix
1. Mesic meadow				
Graminoids		Dactylis glomerata	Orchardgrass	10
		Deschampsia cespitosa	Tufted hair grass	9
		Elymus canadensis	Canada wild rye	6
		Festuca rubra	Creeping red fescue	9
		Koeleria macrantha	Prairie junegrass	10
Forbs		Actaea podocarpa	Yellow cohosh	9
		Agastache foeniculum	Lavendar hyssop	10
		Dicentra eximia	Wild bleeding heart	10
		Dracocephalum parviflorum	American dragonhead	9
		Iris lacustris	Dwarf lake iris	9
		Phemeranthus teretifolius	Appalachian flameflower	9
2. Rain meadow				
Graminoids		Calamagrostis canadensis	Blue joint grass	8
		Chasmanthium latifolium	River oats	12
		Glyceria canadensis	Rattlesnake manna grass	12
		Panicum flexile	Wiry panic grass	12
		Poa palustris	Fowl bluegrass	6
		Spartina pectinata	Freshwater cord grass	6
Forbs		Clinopodium arkansanum	Limestone wild basil	8
		Galium obtusum	Bluntleaf bedstraw	8
		Helenium autumnale	Fall sneezeweed	8
		Lathyrus palustris	Marsh vetchling	6
		Lobelia cardinalis	Cardinal flower	8
		Monarda didyma	Scarlet beebalm	6

MEADOW PLANT LIST